

Previous layout approved 09/00282/mout

REVISED PLAN

All levels approximate and subject to final confirmation.

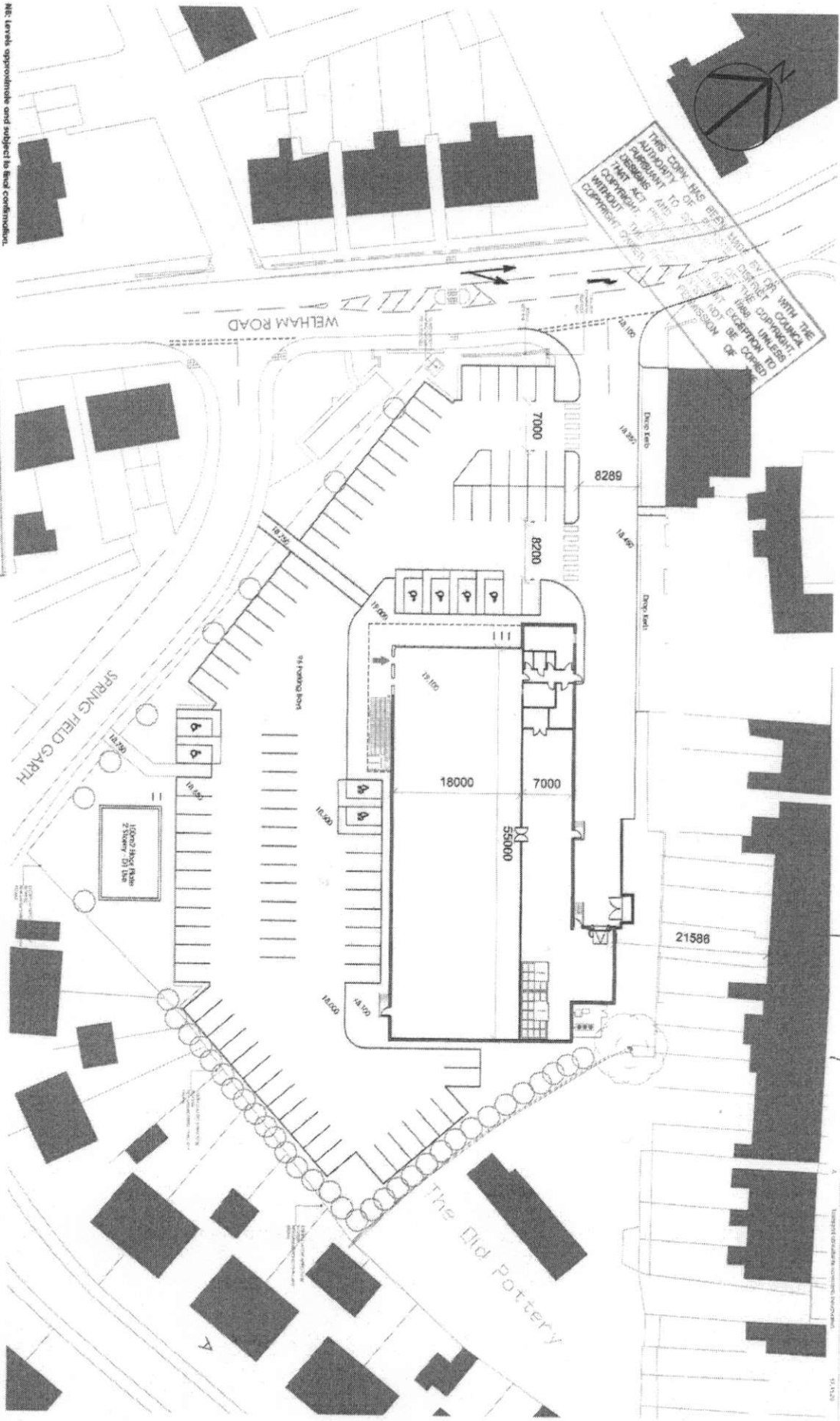

THIS COPY HAS BEEN SUBMITTED TO THE DISTRICT COUNCIL BY OR WITH THE AUTHORITY TO OF THE DISTRICT COUNCIL. IT IS NOT TO BE USED FOR ANY OTHER PURPOSE WITHOUT THE PERMISSION OF THE DISTRICT COUNCIL.

09/00282/mout

Client: A&L Stores Ltd
Project Name: Welham Road, Newton
Date: 11.11.09
Scale: 1:200 @ A3
Project: A&L - Welham Road, Newton
Proposed Site Plan: A1 (0) 101
Revision: A

Project Architects:
 Koffman House
 116 Quayside
 Newcastle Upon Tyne
 NE1 3JY
 T: 0191 204007
 F: 0191 204001
 e: admin@projektsarchitects.com
 www.projektsarchitects.com

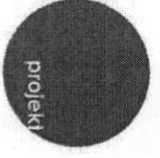

Small text at the bottom right corner, likely a disclaimer or copyright notice.